



B-Lines



Our School Grounds: Making a pollinator improvement plan

Learning Objectives:

Communicate; share experiences, ideas and information.
Explore and discover interesting features of habitats
Improve understanding of conservation and biodiversity

Key Topics: Science, Literacy, Design

Location: Indoors and Outdoors

Equipment:

Paper/pens
Large sheets of paper
Measuring reel (optional)
Compass

Key Words: Habitat, Pollinator, Flower, Nectar, Pollen, Shelter



Background:

How attractive are the school grounds to you? How attractive would the school grounds be if you were a pollinator? We want to look at what we can do on the school grounds to make them better for pollinators, such as bees, butterflies, hoverflies and moths. In this session we will create a plan of the school and annotate it with things we could do to make the school grounds a more attractive place for pollinators and people.

ACTIVITY 1

Depending on the size of the class, you may wish to get small groups of students to map different areas of the school grounds. On your plan, you should show a range of features both natural and man-made, including buildings, grass, flower beds, ponds, hedges and trees.

Include distance measurements and a compass direction. Why might direction be important?

Finally, join the maps together to form one giant plan of your school grounds.



Creating a Flowering bank © Rupert Goddard

ACTIVITY 2

Now its time to get creative – what would make pollinators want to live in your school grounds?

Get the class to discuss what pollinators might need in order to thrive within the school grounds.

Students should think about shelter, warmth and food.

Create a list of things that could be done within the school grounds. You don't want to create conflict so think about different land uses - a wild flower meadow might not be popular with everyone on the school playing field. Spend some time looking to see what areas of the school grounds do not get used very much.

ACTIVITY 3

Finally, annotate your school plan with the features you could add to make the school grounds more attractive to pollinators. Look at the next slide for an example of a Pollinator Improvement Plan.

If your school does not have much area of land that can be improved, why not look at spaces where pollinator friendly window boxes could go? That way you could enjoy the flowers and watch the pollinators in action from the classroom.

Add in some pictures of the school grounds to help people to visualise where your changes could take place. Can you use a computer to help people to understand what you are going to do and how this will help pollinators?

Now that you have created your plan, you can use it as a 'blue print' for all the improvements you want to make.



Example Pollinator Improvement Plan

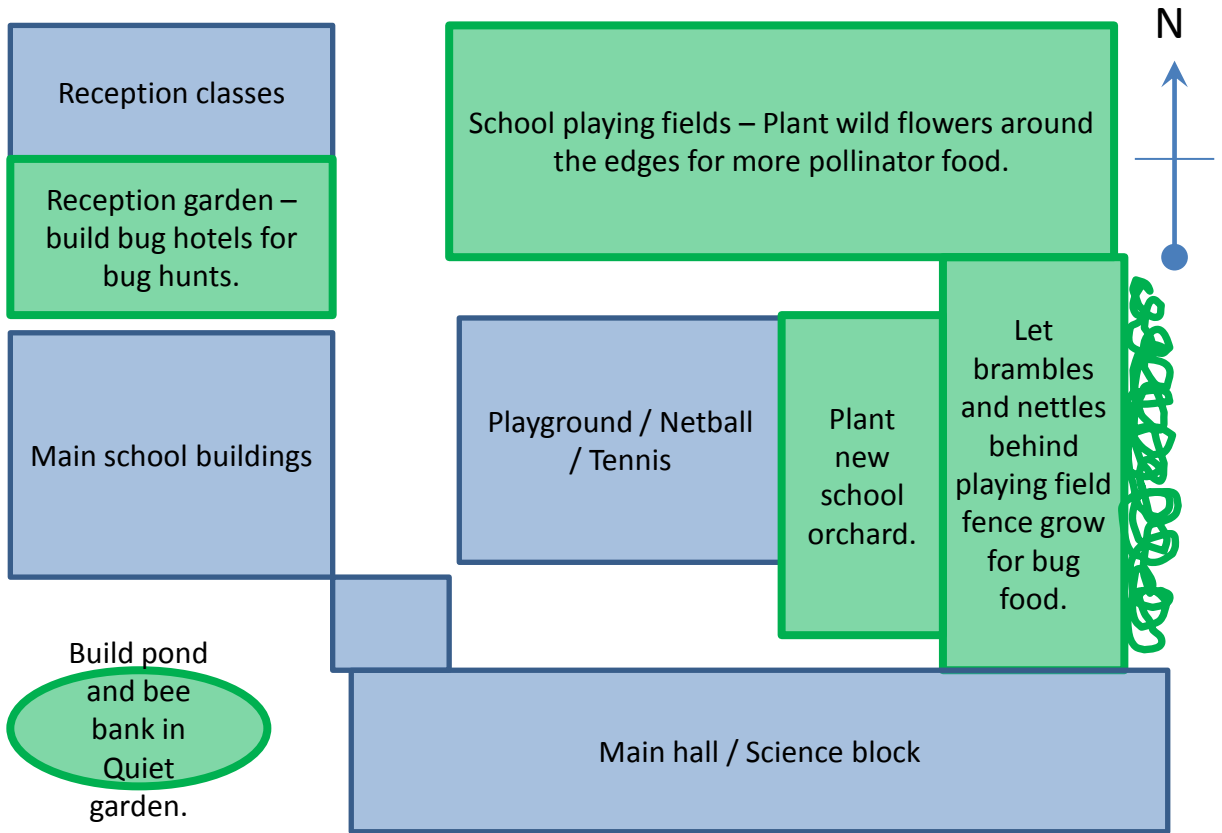

Don't try to make all of your improvements at once. You will probably find that there is too much to do and you may need to fund some of the improvements you want to make. Take your time to ensure success.

Supported by:

J PAUL GETTY JNR
CHARITABLE TRUST

Biffa Award
Building communities. Transforming lives.

**NORTHUMBRIAN
WATER**

Buglife – The Invertebrate Conservation Trust is a company limited by guarantee.

Company No: 4132695. Registered Charity No: 1092293. Scottish Charity No: SC040004. Registered in England at Bug House, Ham Lane, Orton Waterville, Peterborough, PE2 5UU.